



U.S. BASED SUPPORT

HOURS: MONDAY - FRIDAY | 8AM - 5PM EST



1.410.840.3555



support@iagoffroad.com



VIDEO INSTRUCTIONS

<https://www.youtube.com/watch?v=gEsKJbDocvo>



IAG I-Line HD Winch Mount
For 2021+ Bronco
Modular/Capable Bumper

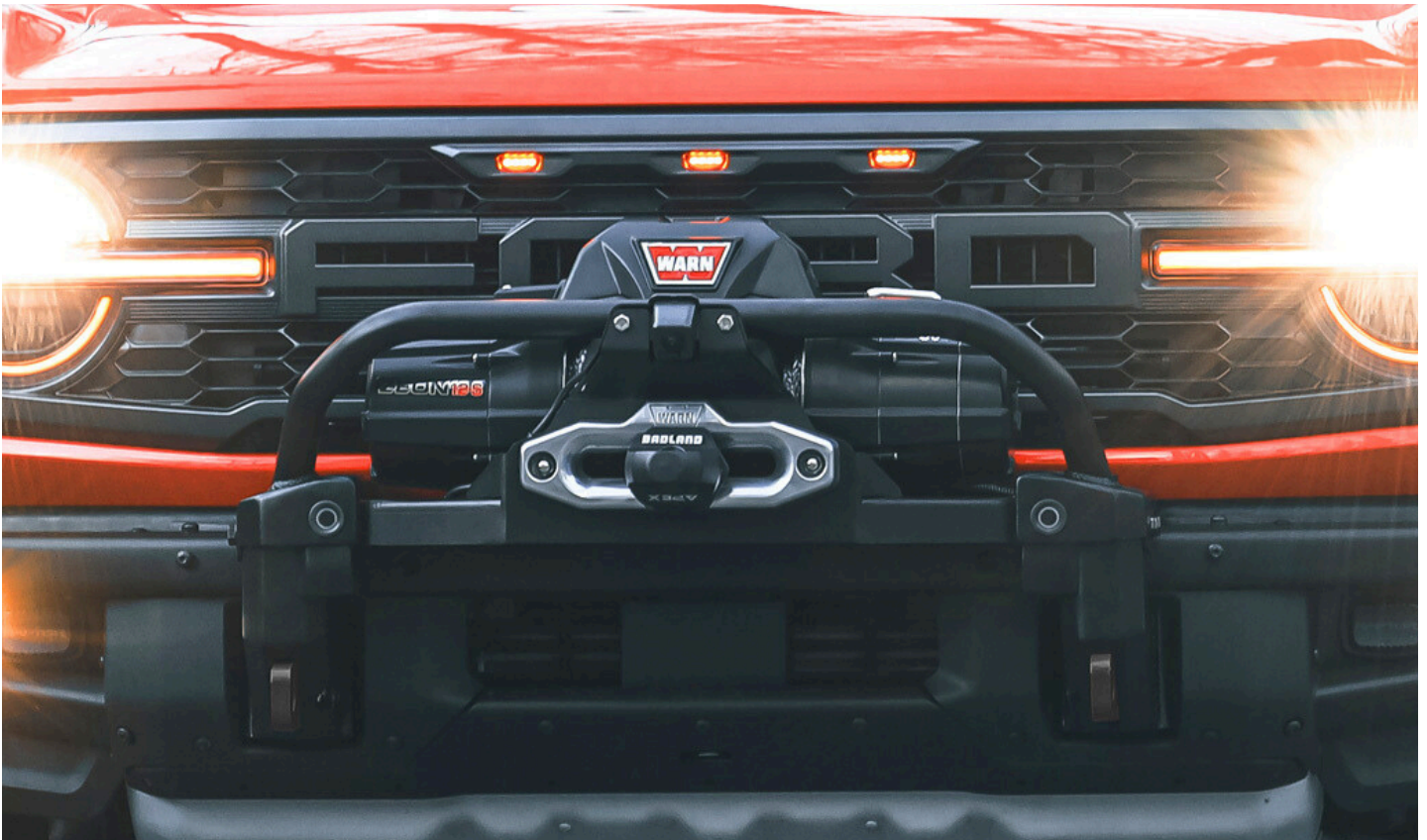



IAG-BDY-F3213 HD Bronco Winch Mount For 2021+ Bronco

Congratulations on the purchase of your HD Bronco Winch Mount, and thank you for choosing IAG Off Road! These instructions are intended for users with basic mechanical skills. Professional installation is not required.

Installation video can be found on our website, or by using the following QR code

Tools Needed:

- Socket or wrench sizes:
Torx 25, 10mm Allen (Low Profile),
5mm Allen, 10mm, 13mm, 15mm, 16mm
- Small pry tool
- Plastic trim pry tool
- Cutting pliers

Scan or click QR code for
instruction video.





- 1** Winch Mount
- 2** (X2) Wiring Cover
- 3** Camera Bracket
- 4** Camera Cover
- 5** (X2) Mount Brackets
- 6** (X2) Tow Hooks



- 8** (X2) Parking Sensor Clips
- 9** (X2) Parking Sensor Block Off
- 10** Camera Extension Harness
- 11** (X2) Parking Sensor Extension Harness
- 12** Washer Fluid Extension Hose



13 (X4) 10mm Allen Bolts

14 (X8) 16mm Bolts

15 (X4) 5mm Allen Bolts

16 (X2) 16mm Nuts

17 (X6) Washers
(Winch Mount)

18 (X4) Washers
(Tow Hooks)

19 (X4) Washers
(Wire/Camera Cover)

20 (X2) 10mm Nuts

21 (X2) Clip Nuts



Step 1

If equipped with front camera, remove the grille

Start by using a small pry tool, and remove the push clips from the radiator shroud. Remove the shroud.

If not equipped the front camera, skip to step 13.



Step 2

Locate the camera connector in front of the air intake.

Depress the tab, and disconnect the front camera harness.



Step 3

Locate the washer fluid hose in front of the air intake.

Squeeze the quick connect fitting, and disconnect the washer fluid hose.

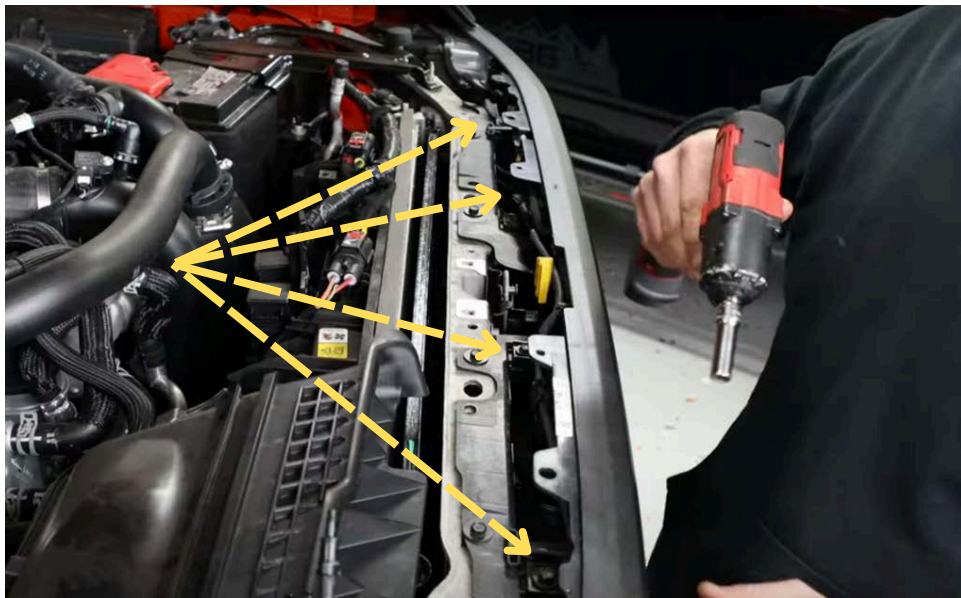

Step 4

Remove the four 10mm bolts from the top of the grille.



Step 5

Using a plastic pry tool, loosen the edges of the grille.

Using even force, pull the grille away from the vehicle to disengage the tabs.

Remove the grille.



Step 6

Disconnect grille harness if equipped.

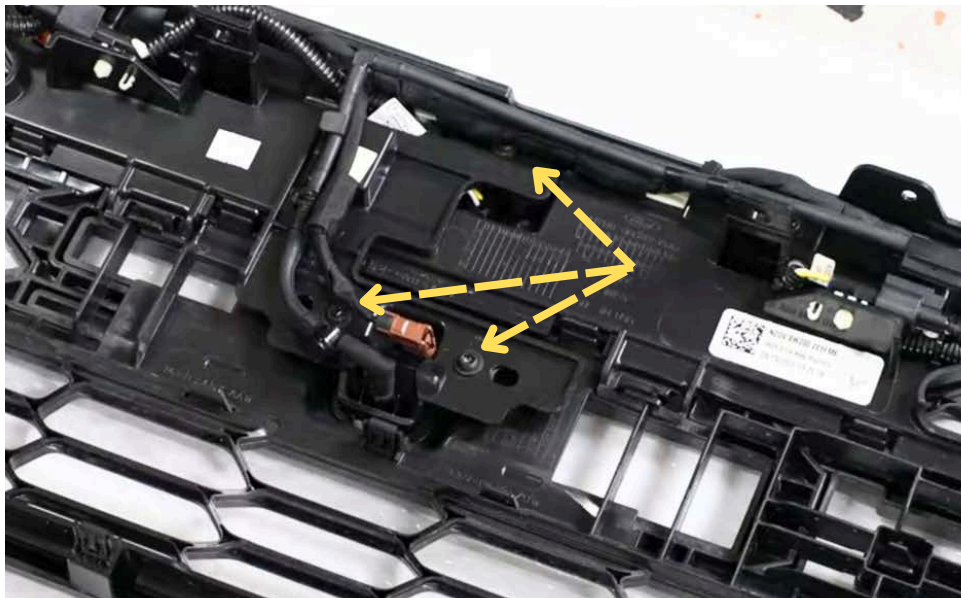

Step 7

Locate the front camera on the back of the grille.

Remove the three Torx 25 screws from the camera cover.



Step 8

Depress the tab, and disconnect the front camera connector.



Step 9

Using a small pry tool, remove the washer fluid hose from the camera.

Leave the small section of hose and valve connected as shown.



Step 10

Reinstall the camera cover without the camera.



Step 11

Reinstall the grille.

Apply even force to the grille when installing to ensure all tabs lock in place.

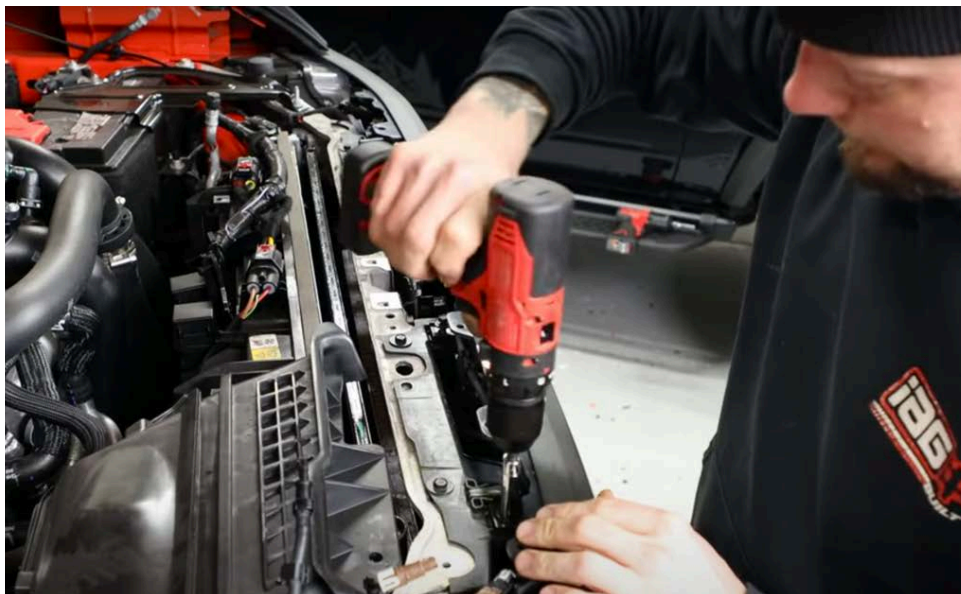

Step 12

Reinstall the four grille bolts.



Step 13

Using a small pry tool, remove the push clips from the bumper trim panel.

Remove the bumper trim panel.



Step 14

Remove the six 15mm bumper bolts.



Step 15

Remove the bumper by lifting up and pulling away from vehicle.

Disconnect the bumper harness if equipped.

Note: Recommend two person lift, for safely removing bumper.



Step 16

Remove the two 8mm bolts from the back of the factory tow hooks.

Remove the factory tow hooks.

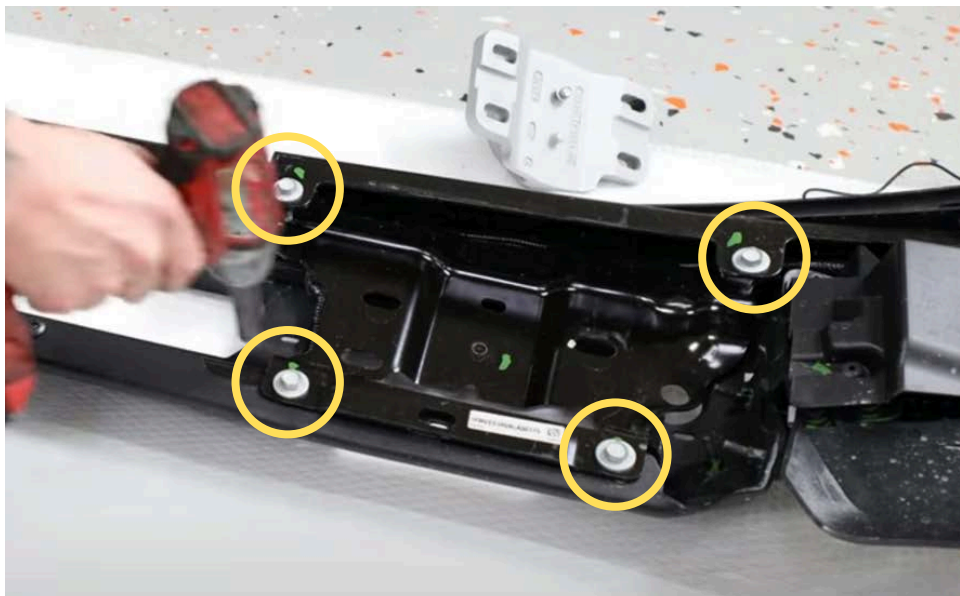

Step 17

If equipped with parking sensors,

Loosen the eight 13mm bolts from the bumper mounting brackets. Remove both bumper mounting brackets.

If not equipped with parking sensors skip to step 23.



Step 18

Remove the left inner parking sensor from the bumper, and disconnect the sensor from the wiring harness.



Step 19

Connect the Parking Sensor Extension Harness.



Step 20

Route Extension Harness through bumper, using existing parking sensor hole.



Step 21

Repeat process for right inner parking sensor.



Step 22

Reinstall both bumper mounting plates with factory hardware.

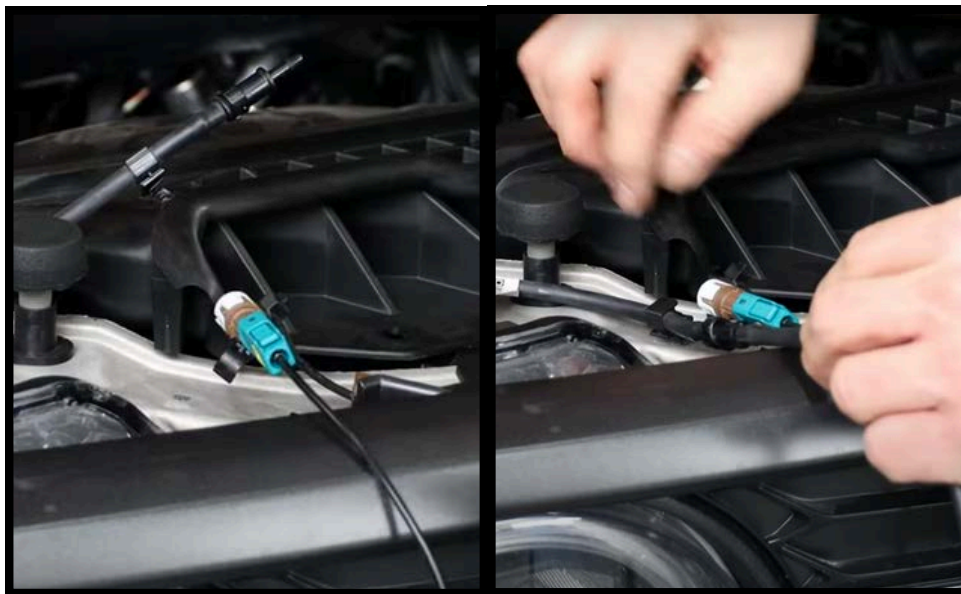

Step 23

Locate the camera connector and hose near the intake.

Install the Camera Extension Harness.

Install Washer Fluid Extension Hose.

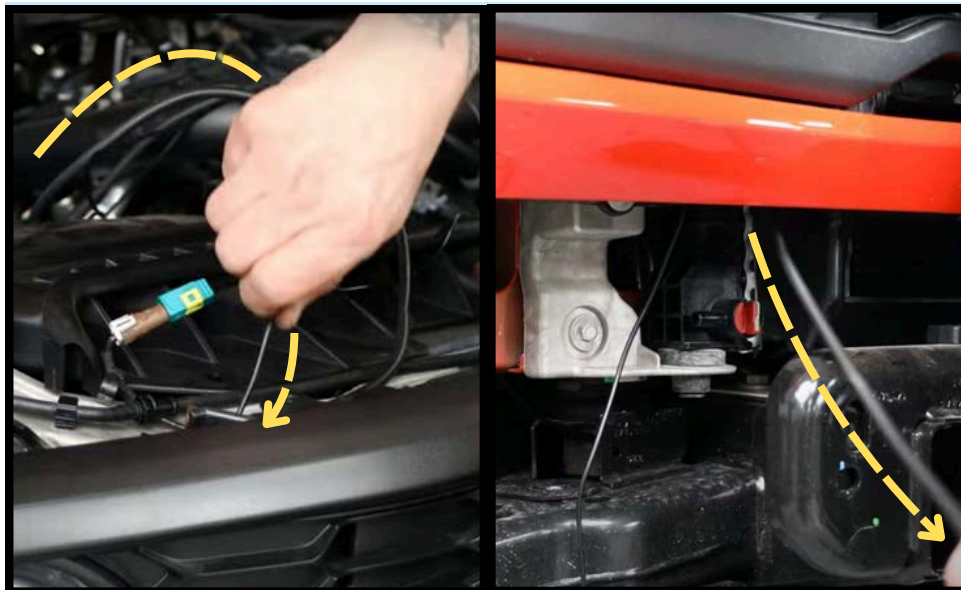

Step 24

Route both extensions behind the grille and toward the bumper.



Step 25

Reinstall bumper.



Step 26

Install the Tow Hook Mounts, reuse factory bumper bolts.

Snug bolts but do not tighten.

5



Step 27

Install the Winch Mount for alignment.

1





Step 28

Use the six provided 16mm bolts and washers.

Snug bolts but do not tighten.



Step 29

Adjust bumper alignment.

Ensure that the bumper is centered on the vehicle, and align the bumper height.

Once bumper is aligned tighten the six bumper bolts.



Step 30

Loosen the Winch Mount Bolts and remove the Winch Mount from the Tow Hook Mounts.



Step 31

Reinstall the bumper trim panel over the Tow Hook Mounts.



Step 32

Install the new Tow Hooks with four provided 10mm Allen Bolts and Washers.

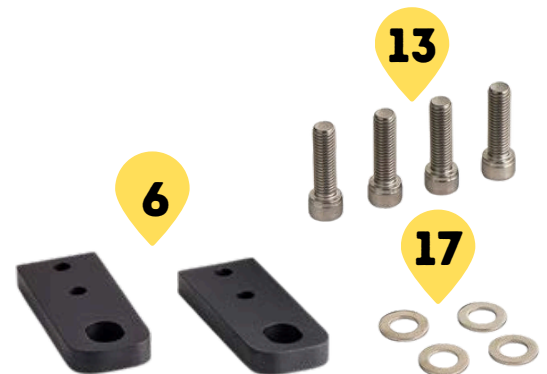

Step 33

Reinstall the Winch Mount. Reinstall and tighten the bolts.



Step 34

Install the new Parking Sensor Clips.

If not equipped with parking sensors, install the Parking Sensor Block Offs.



Step 35

Install the factory parking sensor into the new location.

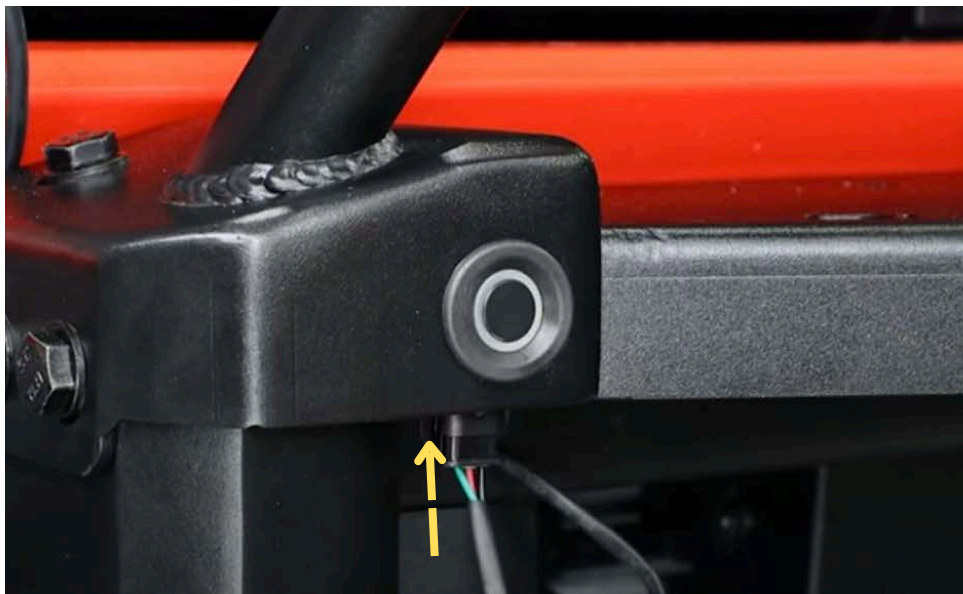

Step 36

Connect Extension Harness into the parking sensor.



Step 37

Repeat process for other side.



Step 38

Prepare the Wire Cover, Clip Nut, and Allen bolt with washer.

Install Clip Nut onto Wire Cover.



Step 39

Install Wire Cover and 5mm Allen Bolt onto Winch Mount. Tighten Allen Bolt.

Repeat for other side.



Step 40

Install the Camera Bracket and desired fairlead onto the Winch Mount.

Use either provided 16mm bolts and nuts, or hardware from desired winch.

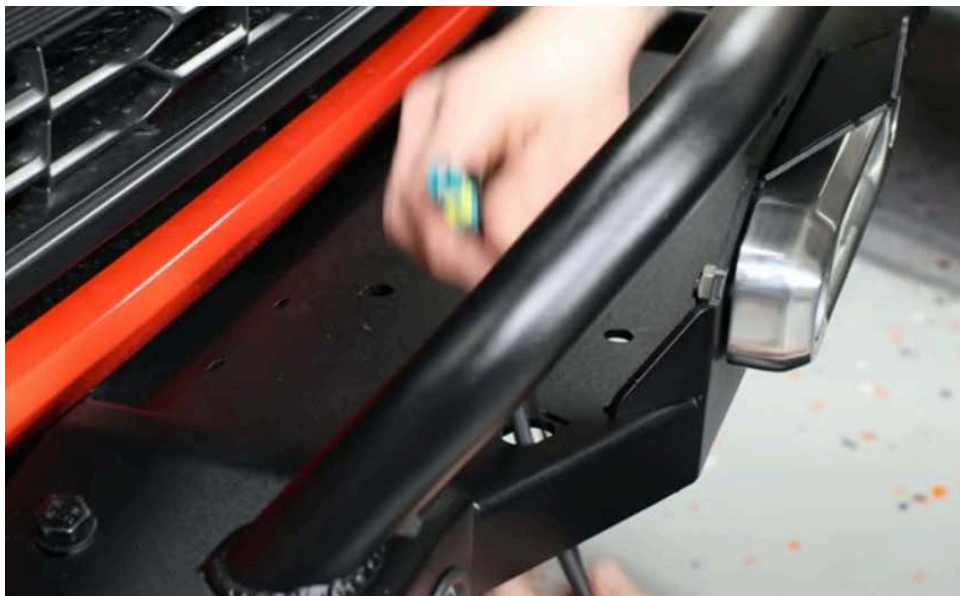

Step 41

Route camera Extension Harness and Hose through the Winch Mount.



Step 42

Connect the Extension Harness and Hose to the Front Camera.

Rotate the washer fluid hose to point towards the passenger side.



Step 43

Install the camera and Camera Cover onto the bracket.



Step 44

Install two provided 5mm Allen bolts, 10mm nuts, and washers.

Tighten the bolts.



Step 45

Install Zip ties to secure extensions.

Trim excess ziptie.



Step 46

Install Zip tie to secure excess hose and wiring.

Trim excess Zip tie.



Step 47

Reinstall radiator shroud.



If you have any questions about the product or install please reach out to support@iagoffroad.com or call 410-840-3555