

***IAG EZ Pull Soft Top Release for 2021+ Ford Bronco
4-Door with Soft Top***





IAG-BDY-F1004 EZ Pull Soft Top Release for 2021+ Ford Bronco 4-Door with Soft Top

Congratulations on the purchase of your IAG EZ Pull Soft Top Release and thank you for choosing IAG Off Road! These instructions are intended for users with basic mechanical skills. Professional installation is not required.

Video instructions can be found here:

<https://youtu.be/75J1fppmuvo?si=g4l71b9d06LXgJjt>



1 Top Cover

2 Lower Cover

3 x2 Paracord Grab Handles

4 Nylon Release Handle

5 Driver Side Latch Assembly

6 Pass. Side Latch Assembly

7 Rod w/ 90 Degree End

8 x2 U Spacer

9 Hardware Kit



Tools needed: Small flathead screwdriver, 10mm nut driver, 3mm allen key, t25 & t30 torx, tape measure, painters tape



Step 1

Remove the rear window and then disconnect the top of the strut.



Step 2

Use a small flathead screw driver to pull the clip.

With the clip disengaged pull the strut off the ball mount.



Step 2 pt.2

Repeat for both sides.



Step 3

Remove the 10mm prop rod nut.



Step 4

Remove the prop rod.



Step 5

Twist the prop rod clip and remove.

Step 5 pt.2



Step 6

Remove the two 10mm latch nuts and then remove the latch.



Step 6 pt.2





Step 7

Remove the two 10mm latch nuts and then remove the latch on the other side.



Step 7 pt.2



Step 8

Slide the two studs out then install the latch with tip towards the outside of the vehicle.



Step 8 pt.2



Step 9

Reinstall the two 10mm nuts from step 6 but do not tighten.

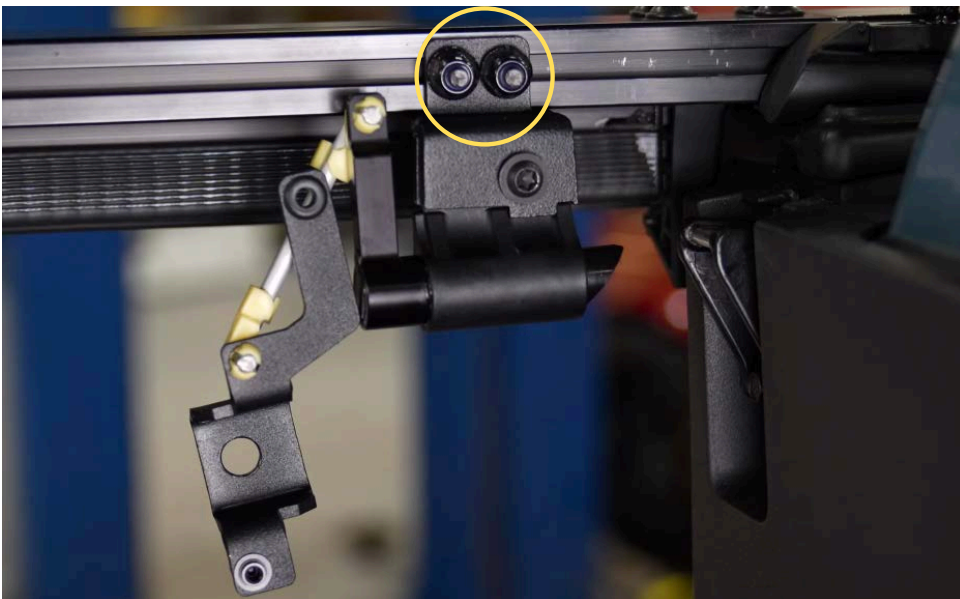

Step 10

Place the U spacer on the latch assembly and push it against the outer catch to align.



8



Step 10 pt.2



Step 11

Tighten the two 10mm latch nuts.



Step 12

On the other side slide the two studs out then install the latch with tip towards the outside of the vehicle.



6



Step 12 pt.2



Step 13

Reinstall the two 10mm nuts from step 7 but do not tighten.



Step 14

Place the other U spacer on the latch assembly and push it against the outer catch to align.



Step 14 pt.2

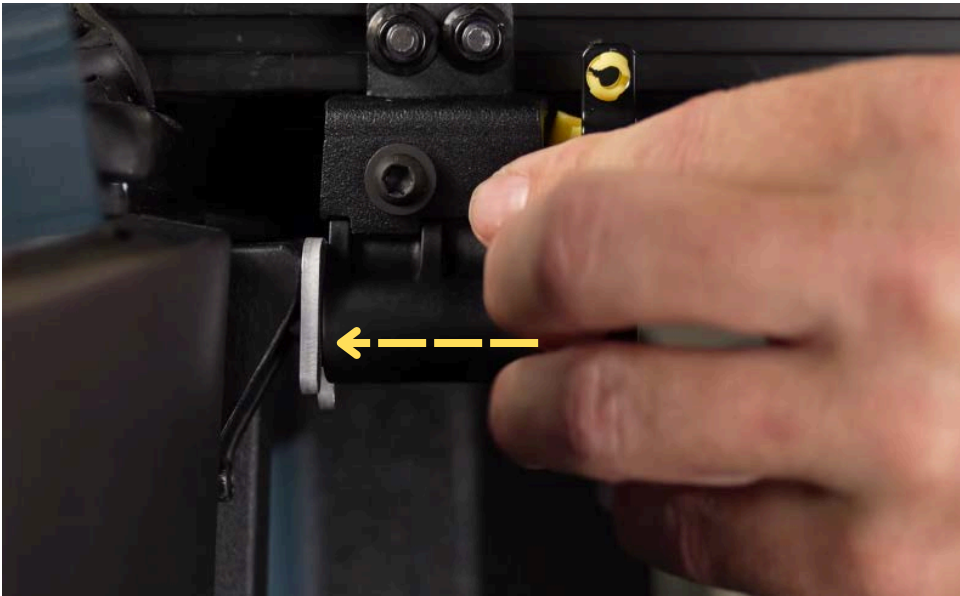

Step 15

Tighten the two 10mm latch nuts.



Step 16

Install the bushing and washer to the latch rod assembly.



Step 16 pt.2

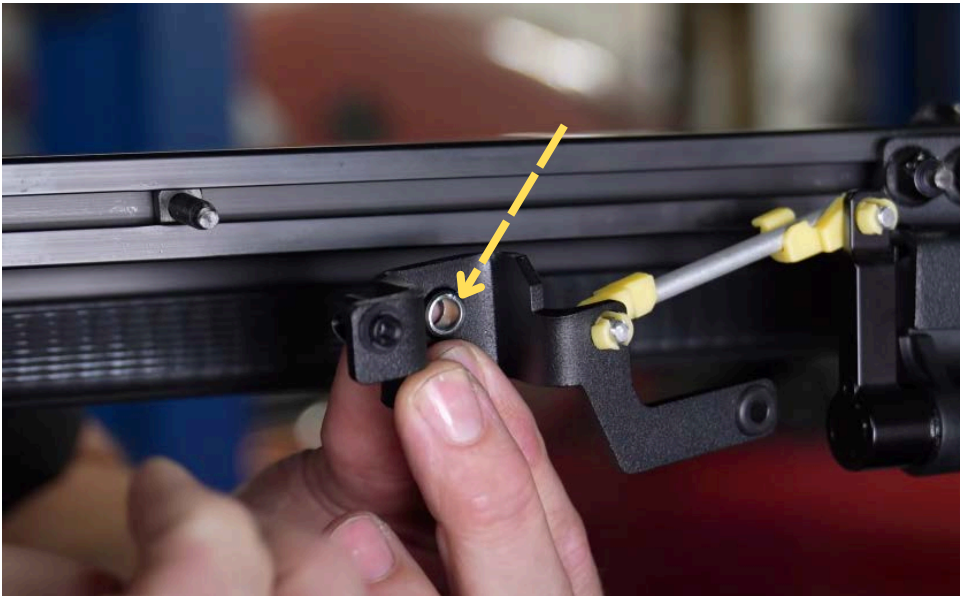

Step 16 pt.3

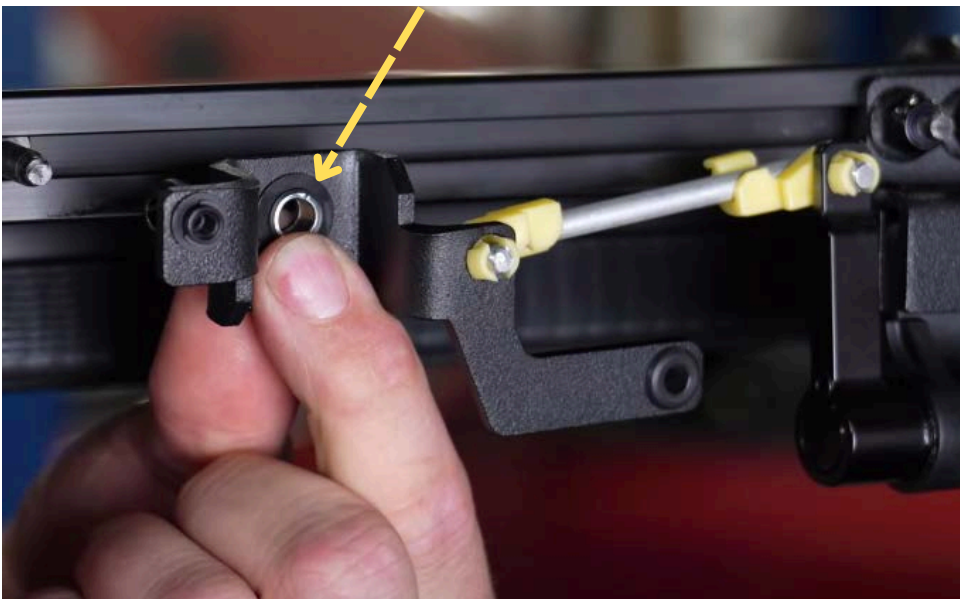

Step 17

Install the latch actuator to the prop rod stud from step 4.





Step 18

Reinstall the factory 10mm nut from step 3 and tighten.

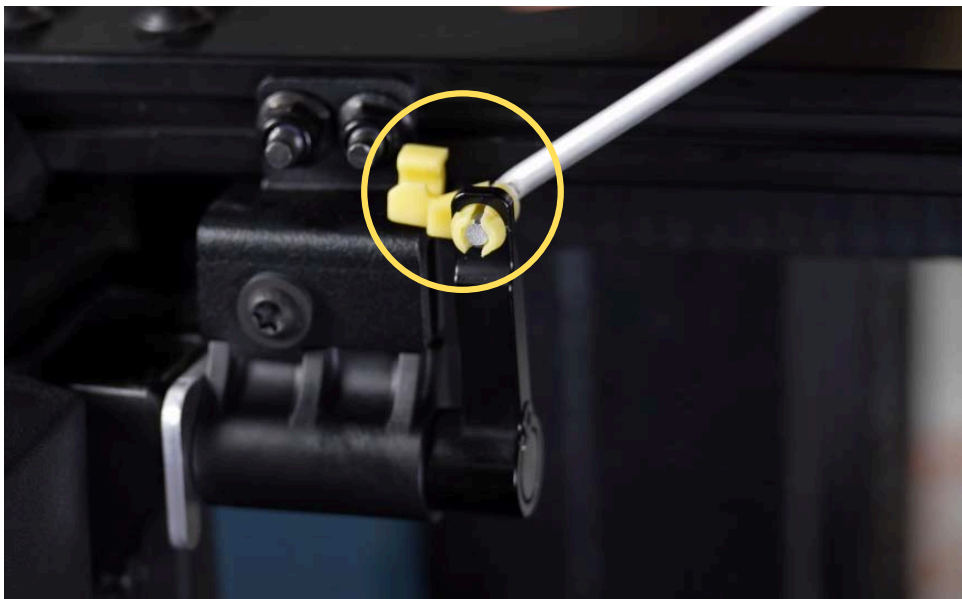

Step 19

Install the 90 degree end from the rod to the rod clip on the passenger side.

7



Step 20

Press yellow rod clip down and lock.



Step 21

Install other end by slightly flexing the rod into the swivel clamp.



Step 22

Tighten with provided allen key.



Step 22 pt.2

Step 23

Install the three allen screws and slotted head nuts to the lower cover.



2



Step 23 pt.2



Step 23 pt.3





Step 24

Place a piece of tape near the middle of the rear window rail.



Step 25

Measure from the outer point of the rear rail and center is around 23.5".



Step 26

Mark the tape at the center.



Step 27

Align with the center mark on the tape and install the lower cover with the nuts in the rail channel.



Step 28

Tighten the center screw.



Step 29

Tighten the other two cover screws.



Step 29 pt.2



Step 30

Locate the T25 screws and slotted head nuts. These will be used to install the grab handles.

3



Step 30 pt.2



Step 31

Loosely install the T25 screws and slotted head nuts to the grab handles.



Step 32

Feed the strap ends up into the cutouts in the lower cover.



Step 33

Install the strap end with the screw and slotted head nut to the rear rail and tighten.



Step 34

Repeat for other end of the grab handle.



Step 35

Repeat steps 32-34 for the other grab handle.



Step 35 pt.2



Step 36

Install the pull lanyard to the actuator.

4



Step 36 pt.2



Step 37

Pull down on lanyard to unlatch the rear and release the U spacers from steps 10 and 14.

Step 37 pt.2



Step 37 pt.3



Step 38

Reinstall the EZ-Lift struts by pushing them back onto the ball mounts.





Step 38 pt.2



Step 39

Repeat for the other side.



Step 39 pt.2



Step 40

Function check the EZ-Pull system.



Step 41

Pull down to make sure it closes securely.



Step 42

Pull down on lanyard to release the EZ-Pull system.

Step 42 pt.2



Step 43

Close system again to prepare for install of the top cover.

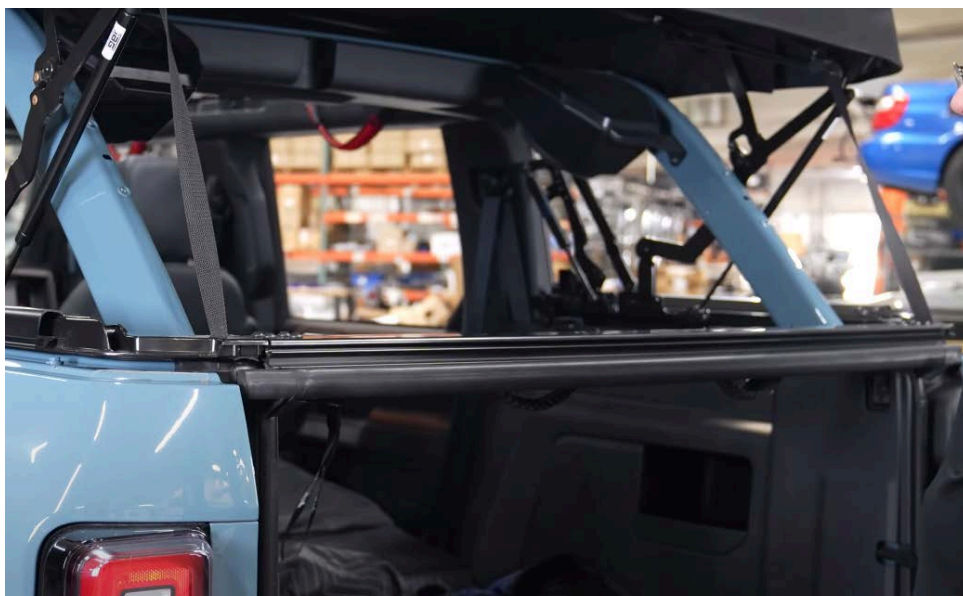

Step 44

Remove the inner two T30 bolts on both sides from the top of the rear rail.

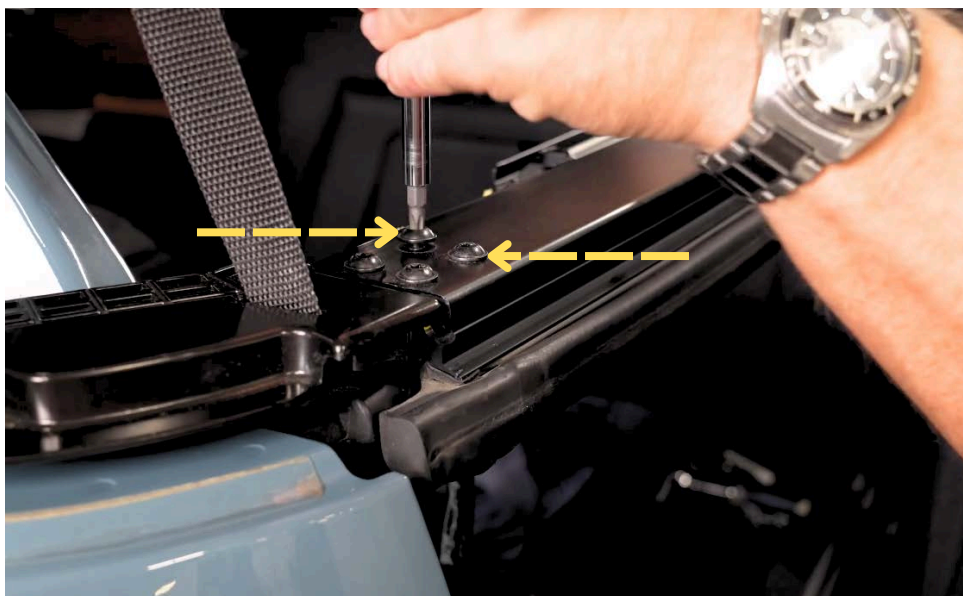

Step 44 pt.2

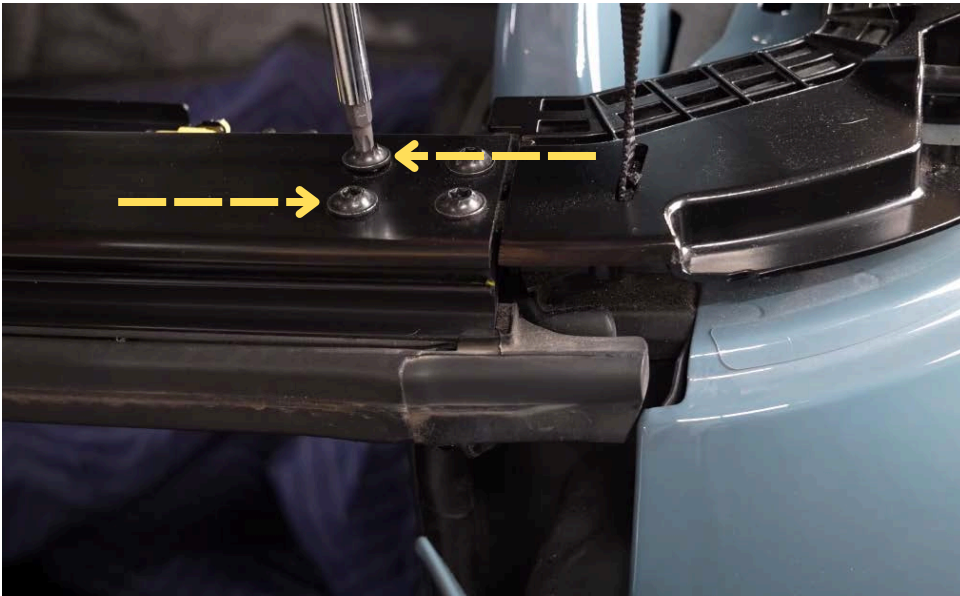

Step 45

Install the top cover by hooking over the lower cover and onto the top of the rail.



1



Step 46

Install the provided T30 bolts to the top cover on the rail but do not tighten.

Repeat for other side.



Step 46 pt.2



Step 47

Install the top cover to the lower cover with the three supplied allen screws.



Step 47 pt.2



Step 47 pt.3



Step 48

Tighten the four T30 bolts from step 46.



Step 48 pt.2

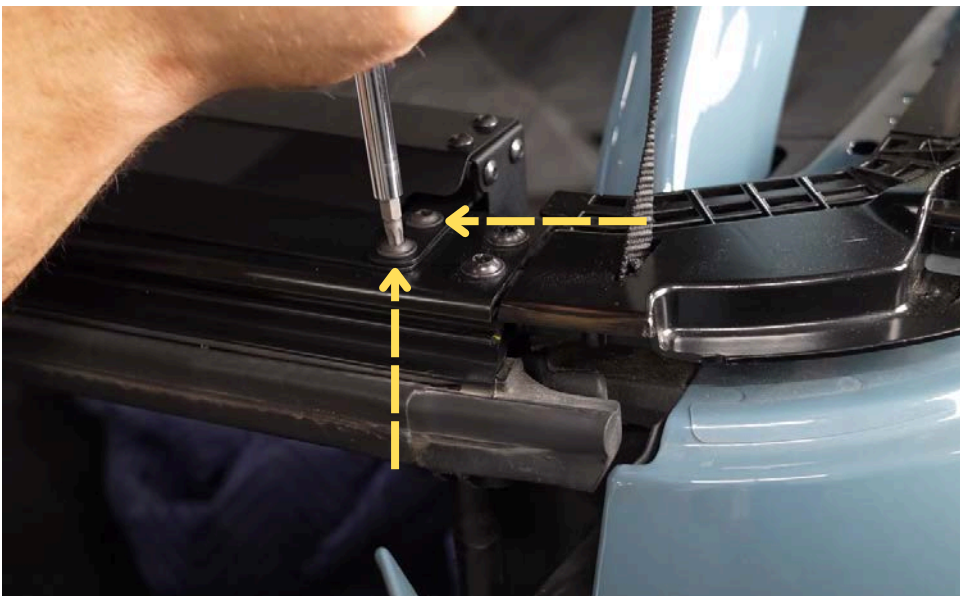

Final install.



If you have any questions about the product or install please reach out to support@iagoffroad.com or call 410-840-3555